

© Crown copyright and database rights Ordnance Survey 100023406. This map has been provided for this drawing and must not be used for any other purpose. Only one paper copy may be made for your own use.

Notes:

- All dimensions are in metres unless noted otherwise.
- This drawing should not be scaled and only written dimensions should be used. Any discrepancies should be brought to the attention of this department immediately.

TRAFFIC ORDER KEY

- No Waiting At Any Time
- No Loading / Unloading At Any Time
- Limited Waiting
- No Waiting At Any Time On Footway
- Traffic Order Boundary

Key--- Additional Information

- Bus Stop
- Bus Stand
- Pedestrian Crossing

Note: Bus stops and pedestrian crossings prevail over underlying waiting restrictions and are shown for information. They are not subject to this order.

*Alin 421*

Duly Authorised Officer

APPROVED FOR SIGNATURE  
Full Council  
31.5.16

Rev	By	Chkd	Apprvd	Date	Description
D	MM	MM	MM	11/04/17	Proposed removed from drawing title Limited Waiting Added to Key
C	KO	MM	MM	28/01/16	Limited Waiting Added to Key
B	KO	MM	MM	18/01/16	Modify No waiting at Whitechurch Lane
A	KO	MM	MM	27/11/15	Various following comments from TR0 Team

Client

BRISTOL ENGINEERING PRACTICE  
Brand House, St Georges Road, Bristol BS1 5BY  
Tel: 0117 322000 Fax: 0117 322015  
Email: engineering@bristolcitycouncil.gov.uk

Project BRISTOL METROBUS NORTH FRINGE TO HENGROVE

Drawing Hengrove Park Waiting Restrictions

Drawn by: KO	Date: 10/02/2015
Checked by: MM	Date: 13/02/2015
Approved by: AB	Date: 13/02/2015

Drawing No. E14017-TRO-500	Revision D
----------------------------	------------

Drawing Scale: 1:1250 @ A3

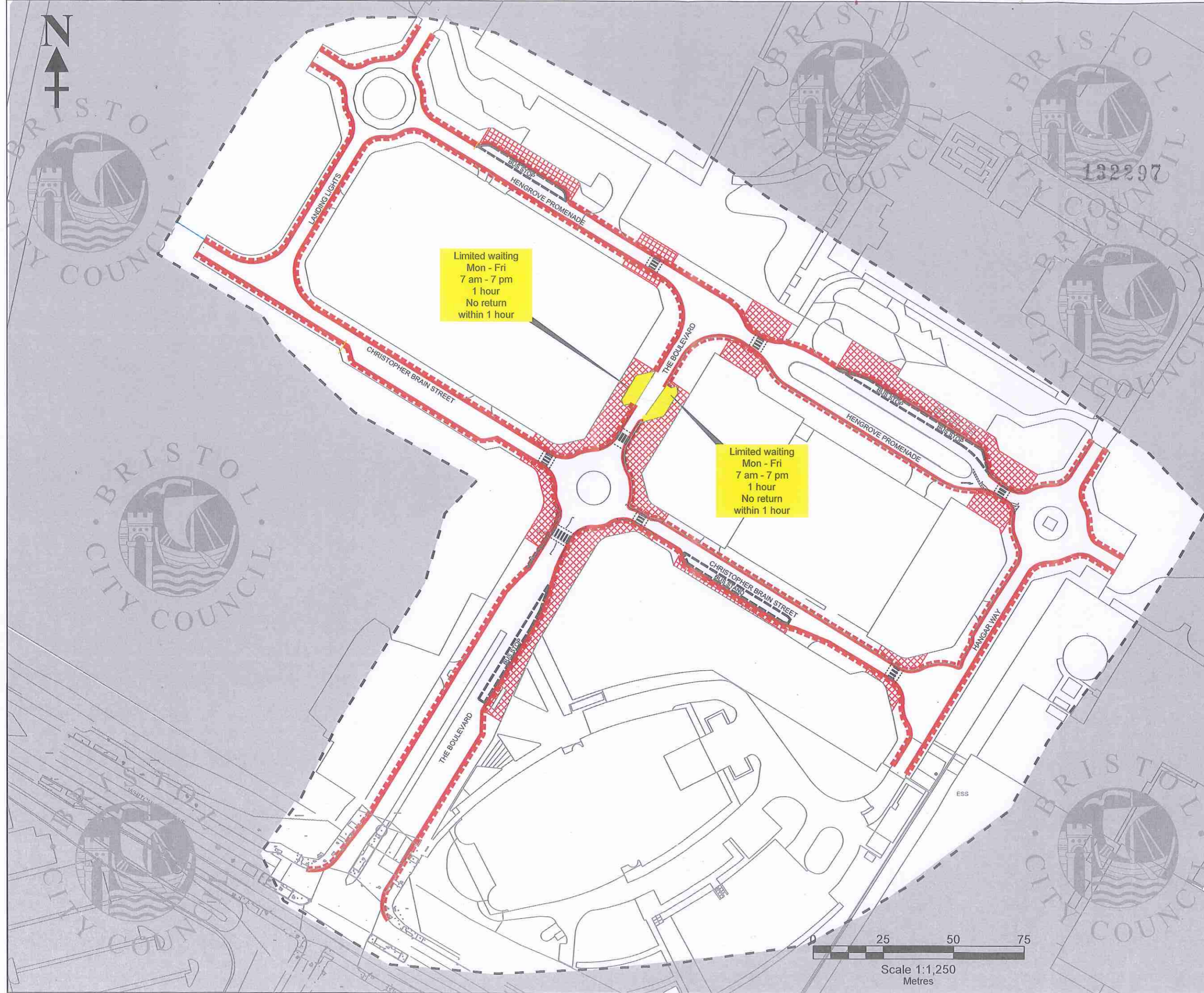

Drawing No. path & name: S:\TRAFFIC\Projects\4017\_Aerial\TR0\Drawings\500\_Hengrove Park Waiting Restrictions\_Hengrove Park Proposed Waiting Restrictions\_Rev.C.dwg Date: 13/02/2015 11:51:16